

QPD8-200-1000

8-Way, 0.2~1GHz

Features:

- * Small Size
- * Low Insertion Loss

Applications:

- * Amplifiers
- * Mixers
- * Antennas
- * Laboratory Test

Electrical

Frequency:	0.2~1GHz
Insertion Loss:	1.4dB max.
Input VSWR:	1.25 max.
Output VSWR:	1.2 max.
Isolation:	20dB min.
Amplitude Balance:	0.4dB max.
Phase Balance:	±4°
Impedance:	50Ω
Average Power:	30W max. 2W max. as combiner

Mechanical

Size* ¹ :	172*138*12mm 6.772*5.433*0.472in
Connectors:	SMA Female
Mounting:	4-Φ3.2mm through-hole

[1] Exclude connectors.

Environmental

Operation Temperature:	-35~+75°C
------------------------	-----------

Outline Drawings

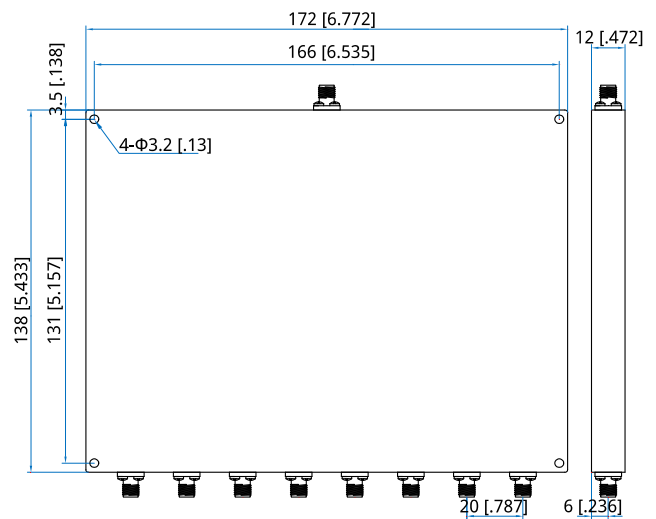

Unit: mm [in]

Tolerance: ±0.5mm [±0.02in]

How To Order

QPD8-200-1000

Customization is available upon request.